

Standardised centrifugal electric pumps built in stainless steel AISI 304

APPLICATIONS

- Water supply to civil, agricultural and industrial plants
- Pressure boosting
- Fire-fighting, heating and air conditioning systems
- Pumping industrial liquids
- Irrigation
- Refrigeration towers
- Swimming pools
- Emptying
- Washing plants

TECHNICAL DETAILS

- Highly resistant structure

PUMP TECHNICAL DATA

- Maximum working pressure: 10 bar
- Temperature of the liquid:
 - 10°C ÷ +90°C
 - 10°C ÷ +110°C
 - 20°C ÷ +120°C

MOTOR TECHNICAL DATA

- High efficiency motors
 - IE1-2 starting
 - IE3 starting
- Self-ventilated 2 and 4 poles asynchronous motor
- Class of insulation F
- IP 55 protection degree

MATERIALS

- Pump casing and casing cover in:
 - AISI 304 for

32-125/160/200

40-125/160/200

50-125/160/200

65-125/160/200

- Mechanical seal standard in:
 - Carbon/Ceramic/NBR
 - Silicon Carbide/Silicon Carbide/FKM
 - special mechanical seals available

JH SERIES

SECTIONAL VIEW 32, 40, 50 SERIES

2 Poles

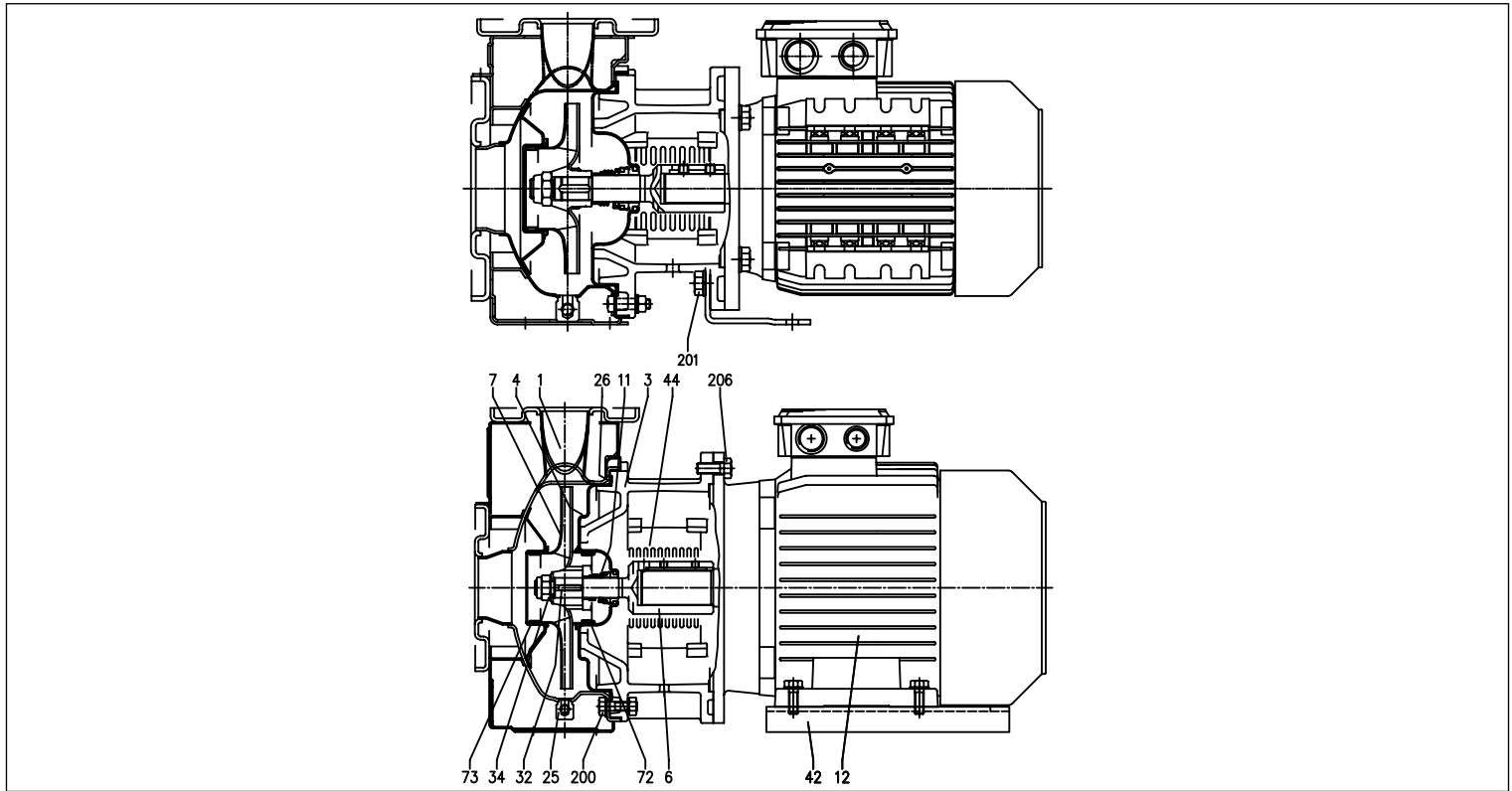

SECTIONAL VIEW 65 SERIES

2 Poles

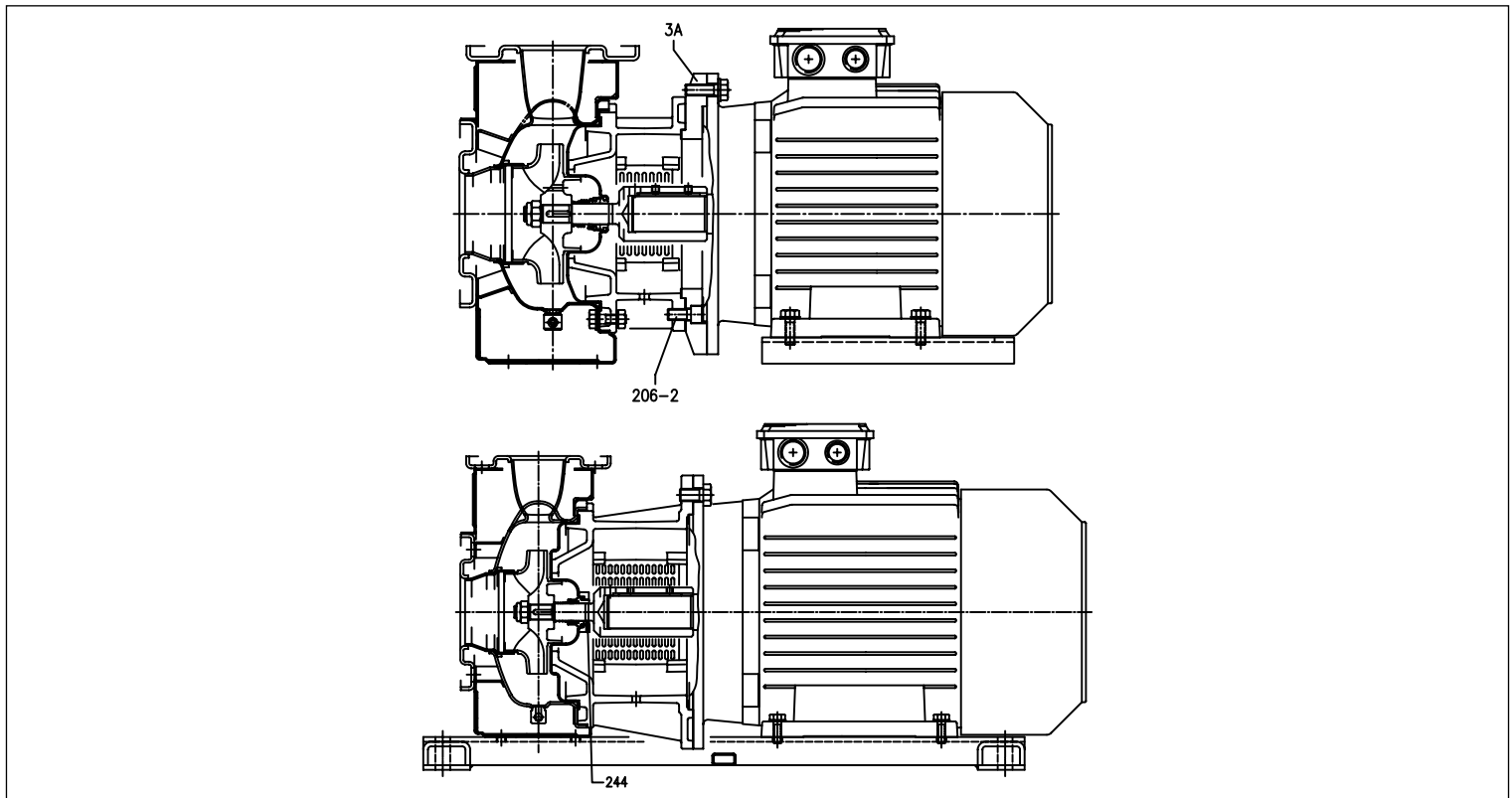

JH SERIES

MATERIALS TABLE

Ref.	Name	304 SS		Materials
001	Pump casing	EN 1.4301 (AISI 304)		
003	Motor bracket			Cast iron EN-GJL-200-EN 1561
003A	Adapter ring [1]			Cast iron EN-GJL-200-EN 1561
004	Casing cover	EN 1.4301 (AISI 304)		
006	Joint - Part in contact with the liquid	EN 1.4301 (AISI 304)		
007	Impeller	EN 1.4301 (AISI 304)		
011	Mechanical seal	Carbon/Ceramic/NBR		
012	Motor			-
025	Plug			EN 1.4401 (AISI 304) / PTFE
026	O-Ring	NBR		
032	Key			EN 1.4401 (AISI 304)
034	Impeller nut	EN 1.4301 (AISI 304)		
042	Motor support			Aluminium / Galvanised steel
044	Support protection			EN 1.4301 (AISI 304)
072	Casing ring [2]	EN 1.4301 (AISI 304)		
073	Casing ring (not for 65)	EN 1.4301 (AISI 304)		
200	Screw (pump body)			Stainless steel A2 70 class ISO 3506/1
201	Screw			Galvanised steel
206	Support screw			Galvanised steel
206-2	Adapter ring screw			Galvanised steel
244	Plug [3]	-		EN 1.4301 (AISI 304)

JH 32 SERIES

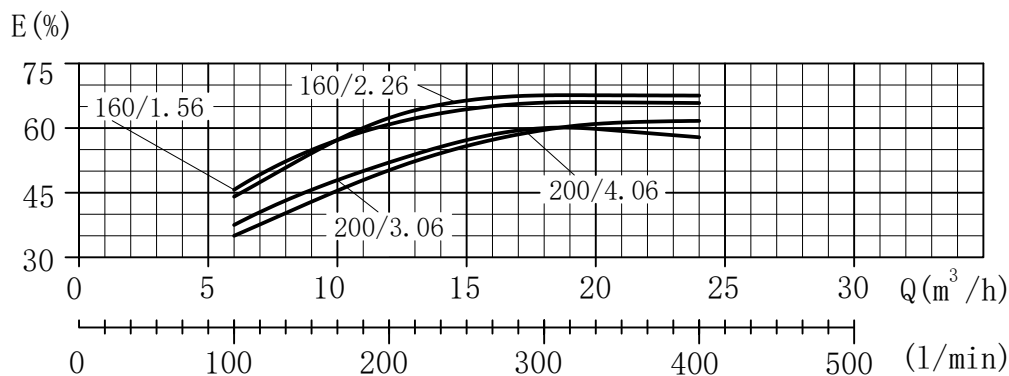
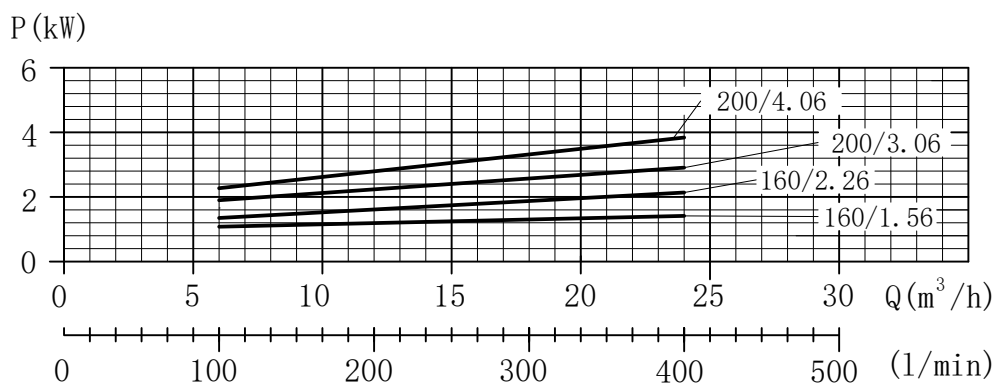
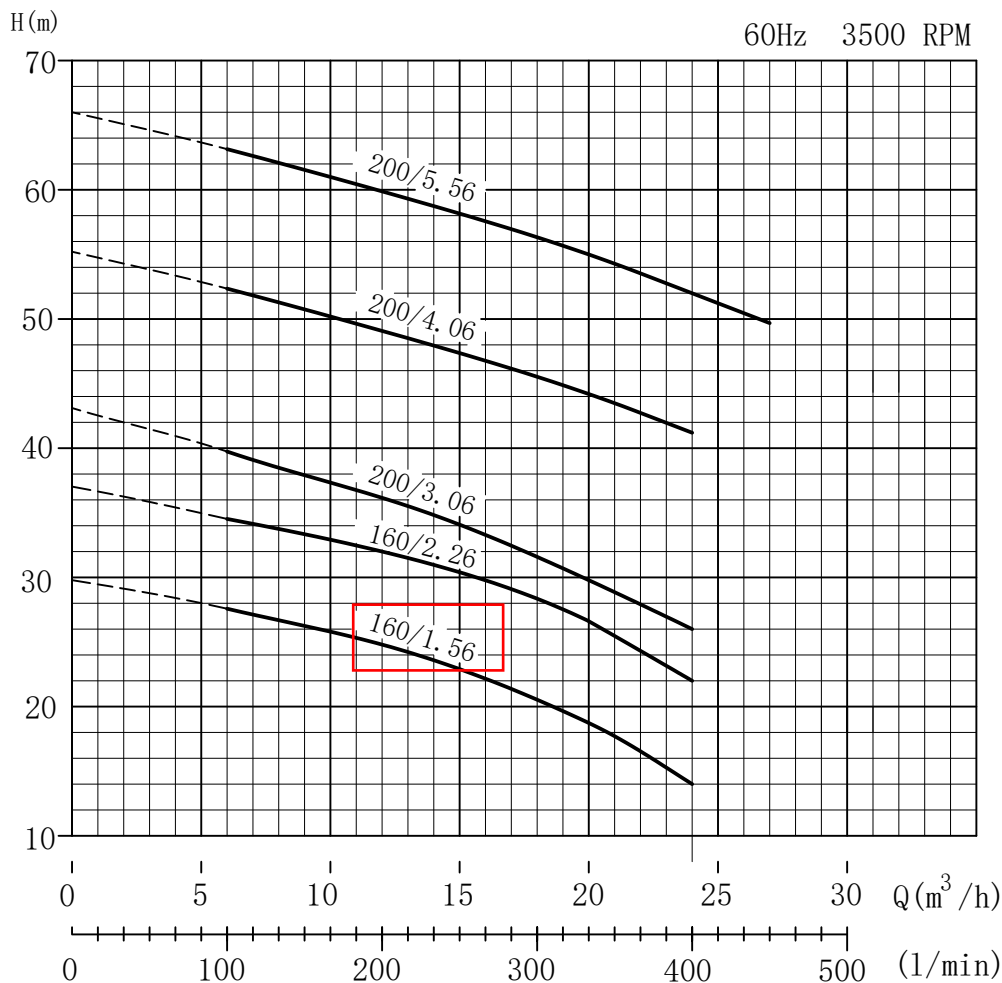

JH 40 SERIES

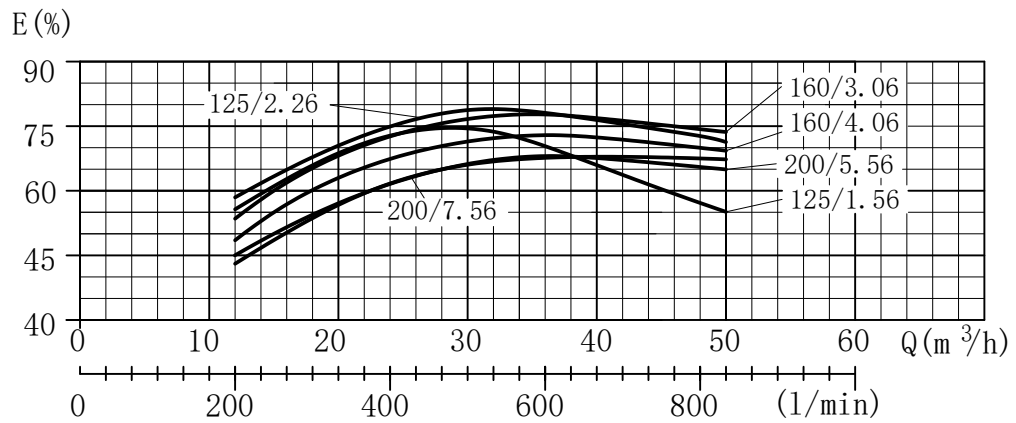
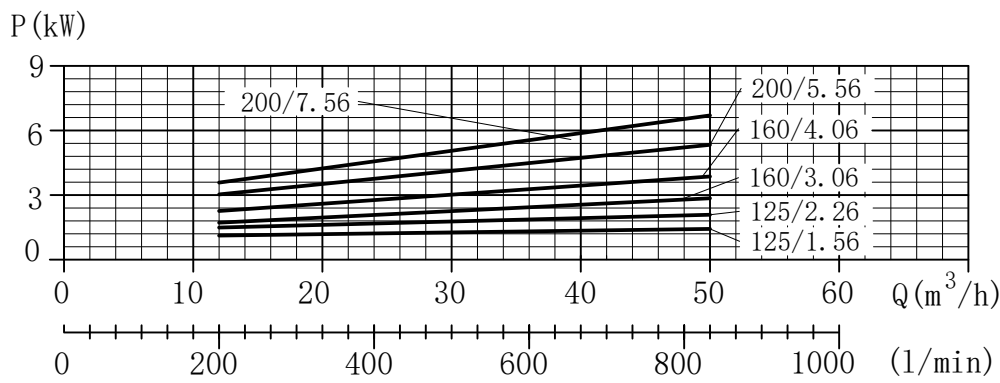
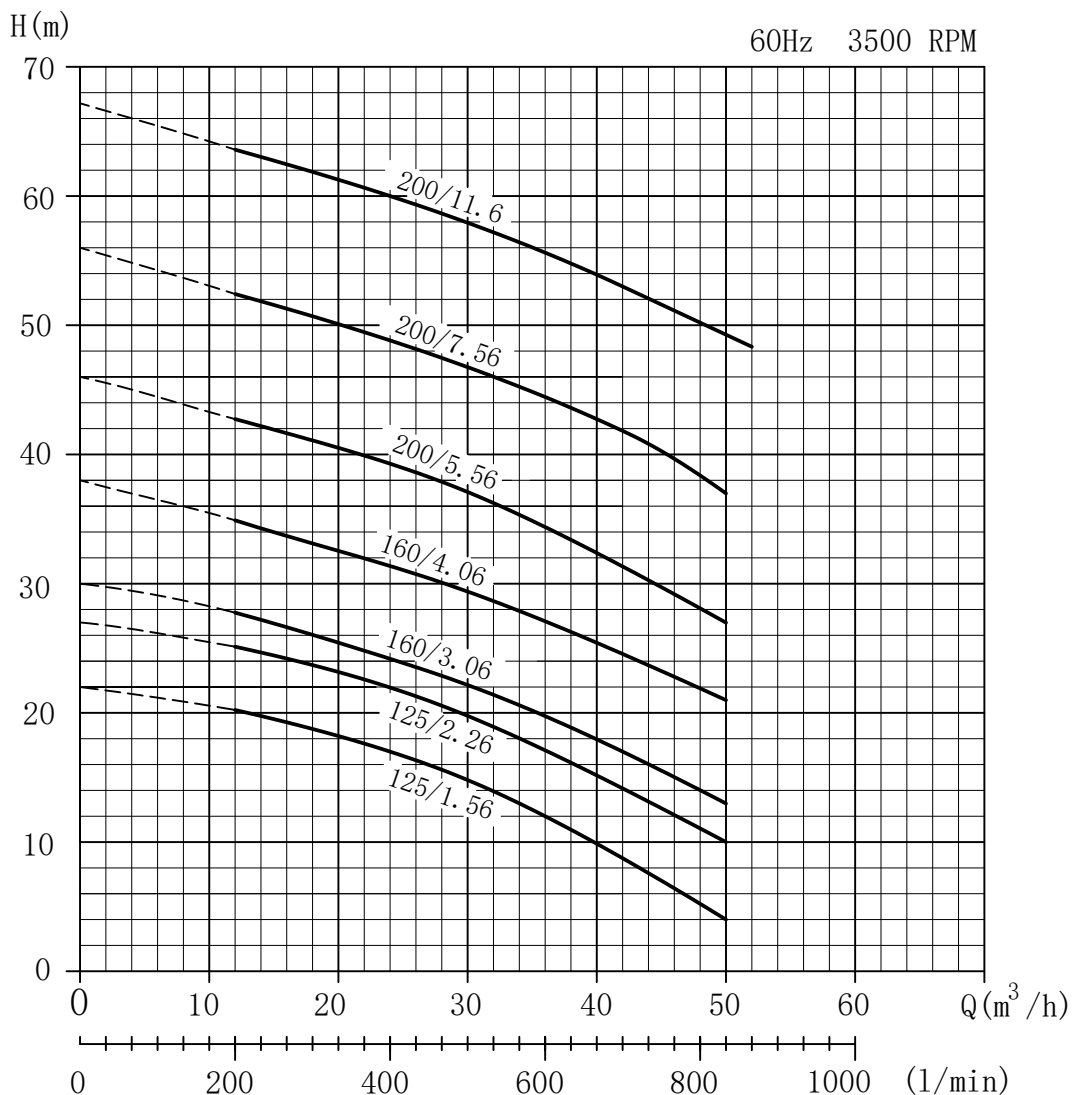

JH 50 SERIES

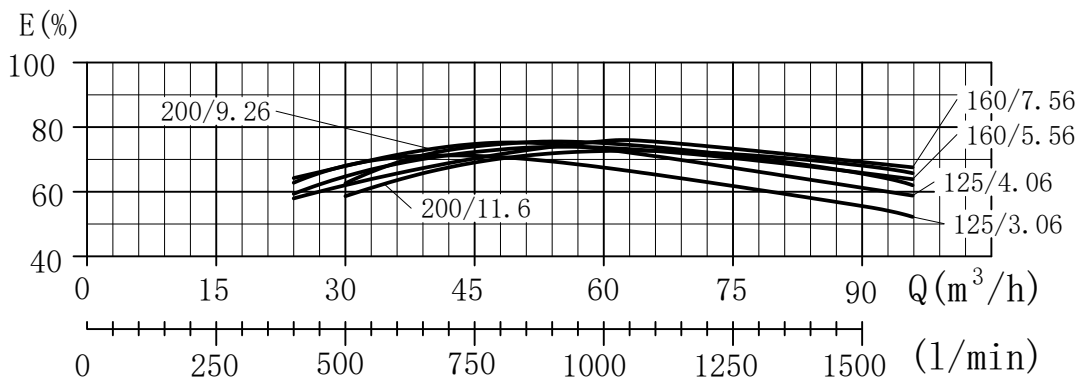
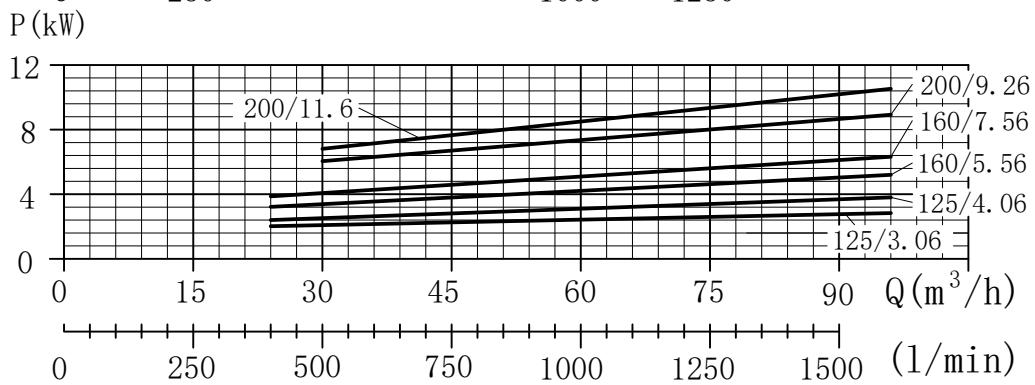
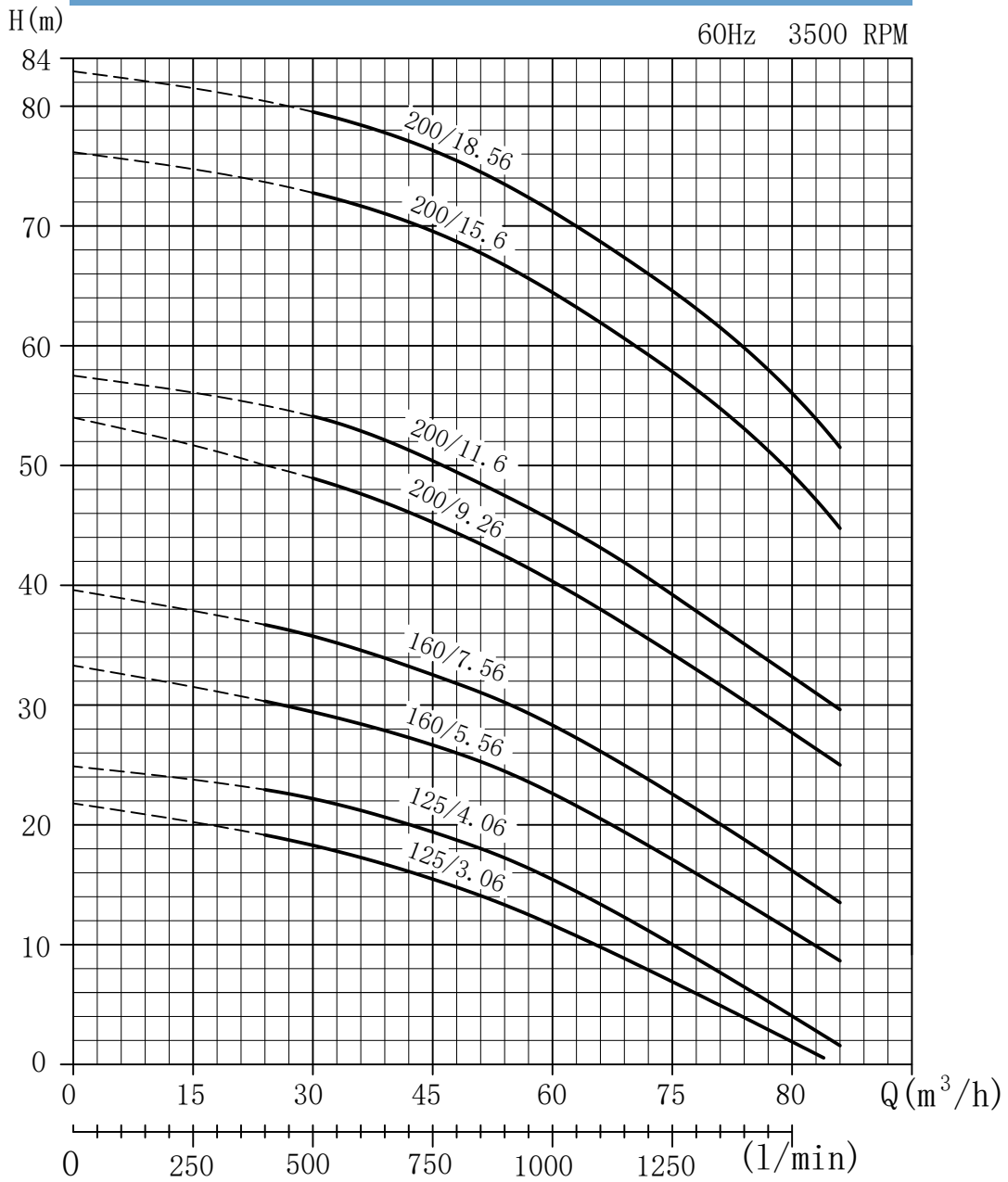

JH 65 SERIES

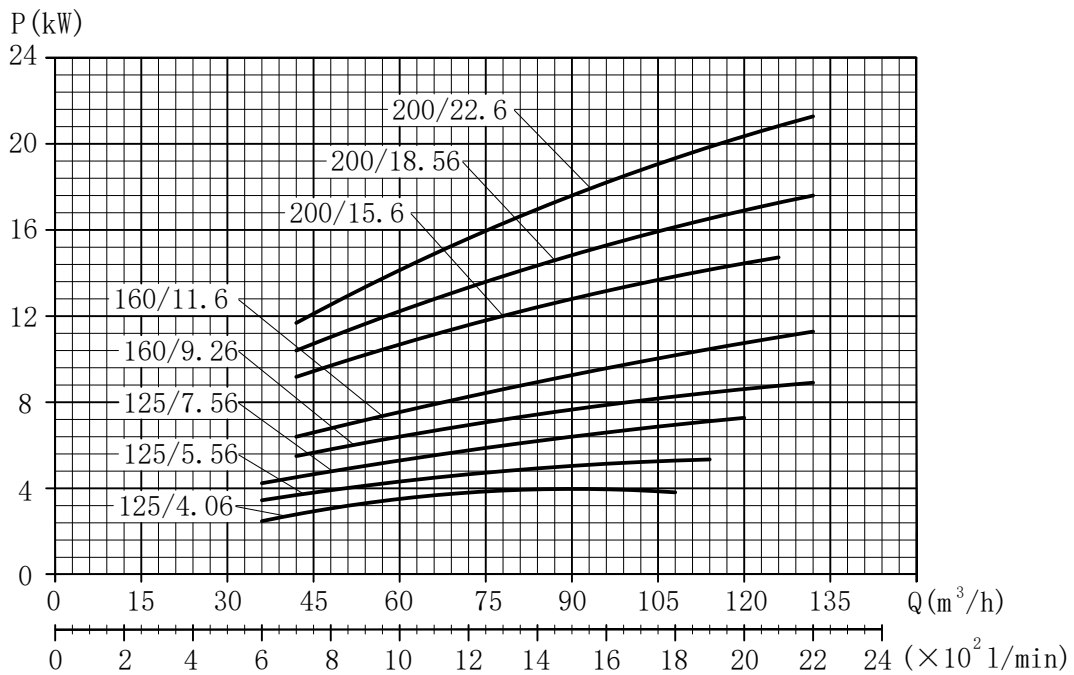
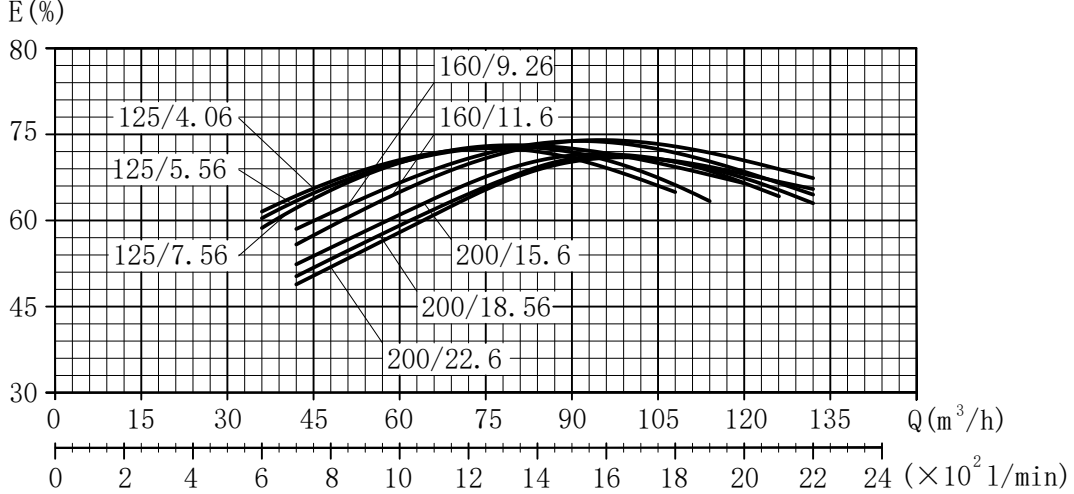
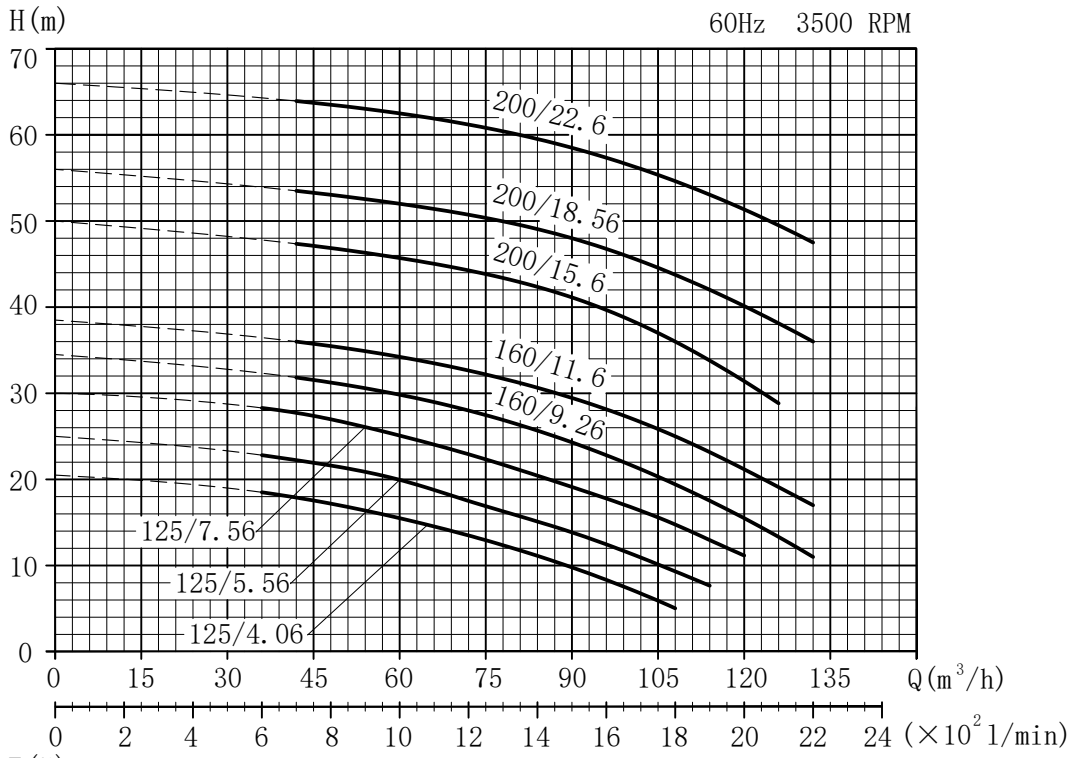

JH SERIES

CENTRIFUGAL ELECTRIC PUMPS STANDARDISED IN COMPLIANCE WITH EN

733

32, 40, 50 - up to 2.2 kW

2 Poles

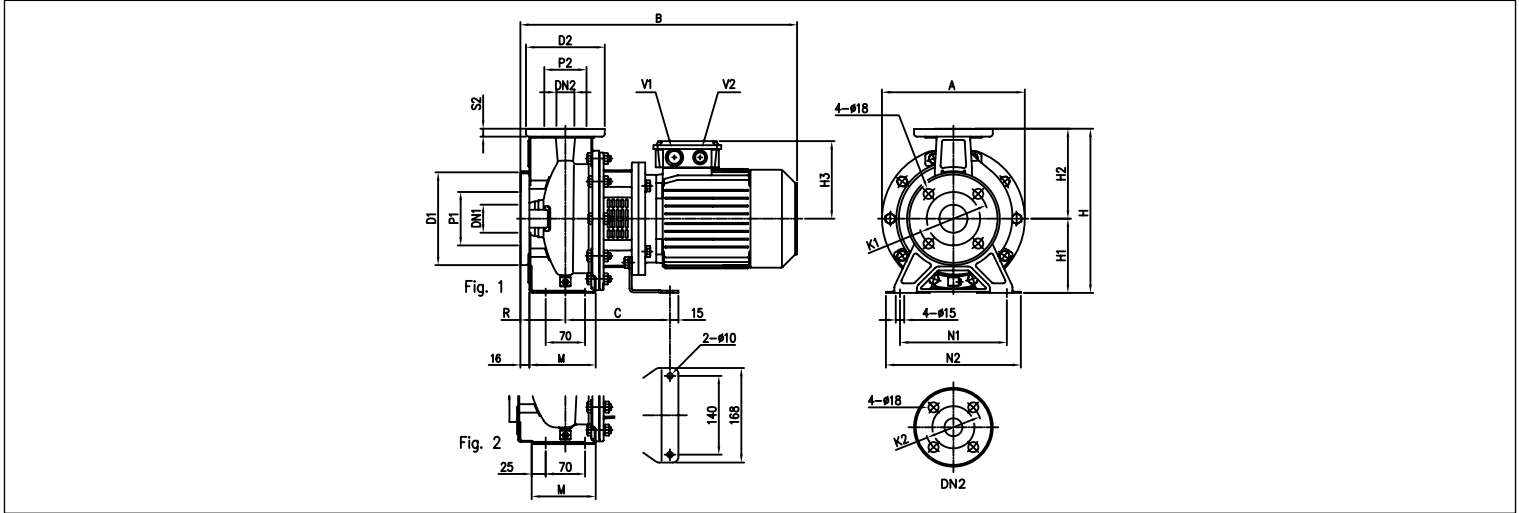

DIMENSIONAL TABLE

Model	DN1 Ø	P1 Ø	K1 Ø	D1 Ø	DN2 Ø	P2 Ø	K2 Ø	D2 Ø	S2	Fig.	Dimensions [mm]							Weight [kg]							
											H	H1	H2	H3	R	M	N1	N2	A	B	C	V1	V2	*	
32-125/1.1	50	95	125	165	32	75	100	140	14	1	252	112	140	139	80	114	140	190	213	430	174	M25x 1.5	M20x1.5	23.1	24.7
32-160/1.5	50	95	125	165	32	75	100	140	14	1	292	132	160	148	80	118	190	240	254	477	186	M25x 1.5	M20x1.5	29.8	29.8
32-160/2.2	50	95	125	165	32	75	100	140	14	1	292	132	160	148	80	118	190	240	254	477	186	M25x 1.5	M20x1.5	32.4	32.4
40-125/1.5	65	115	145	185	40	80	110	150	14	1	252	112	140	148	80	114	160	210	213	477	186	M25x 1.5	M20x1.5	26.5	26.5
40-125/2.2	65	115	145	185	40	80	110	150	14	1	252	112	140	148	80	114	160	210	213	477	186	M25x 1.5	M20x1.5	29.6	29.6
50-125/2.2	65	115	145	185	50	95	125	165	16	2	292	132	160	148	100	114	190	240	254	497	186	M25x 1.5	M20x1.5	32.9	32.9

32, 65 - 3 ÷ 4 kW

2 Poles

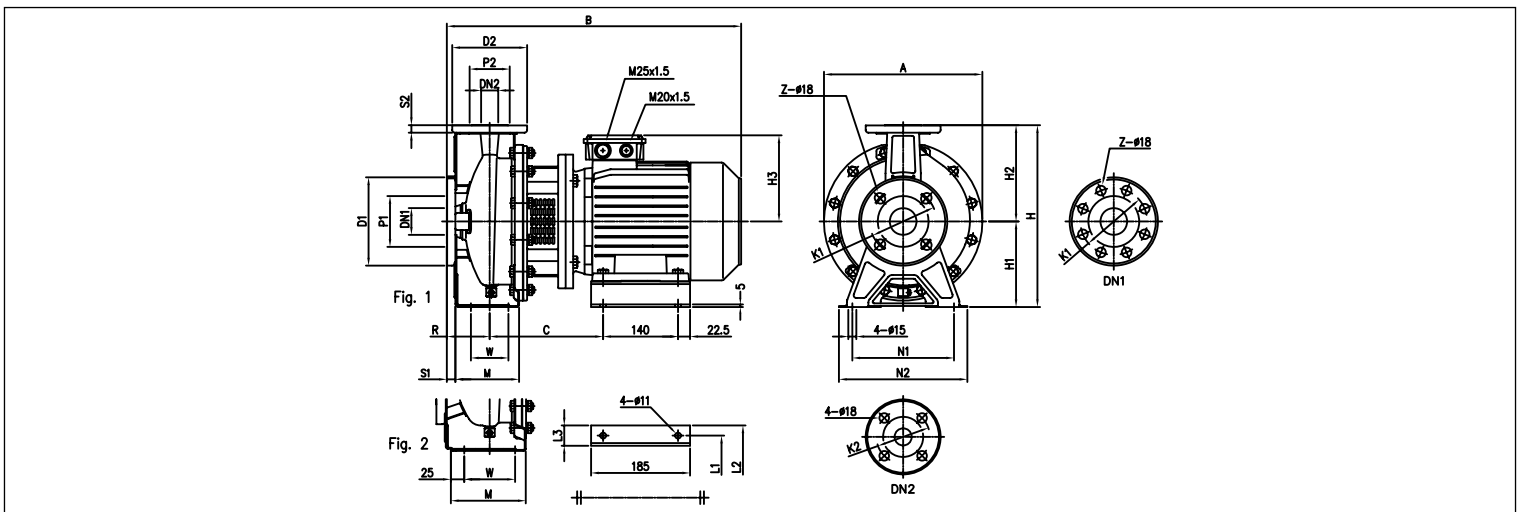

DIMENSIONAL TABLE

Model	DN1 Ø	P1 Ø	K1 Ø	D1 Ø	S1	Z		DN2 Ø	P2 Ø	K2 Ø	D2 Ø	S2	Fig.	Dimensions [mm]							Weight [kg]									
						[1]	[2]							H	H1	H2	H3	R	W	M	N1	N2	A	B	C	L1	L2	L3	*	
32-200/3.0	50	95	125	165	16	4	-	32	75	100	140	14	1	340	160	180	155	80	70	119	190	240	296	528	205	160	202	42	46.9	46.9
32-200/4.0	50	95	125	165	16	4	-	32	75	100	140	14	1	340	160	180	171	80	70	119	190	240	296	550	212	190	228	38	49	49
65-125/4.0	80	134	160	200	18	8	4	65	115	145	185	16	2	340	160	180	171	100	95	140	212	280	254	570	212	190	228	38	50.1	50.1

JH SERIES

CENTRIFUGAL ELECTRIC PUMPS STANDARDISED IN COMPLIANCE WITH EN

733

32, 40, 50, 65

2 Poles

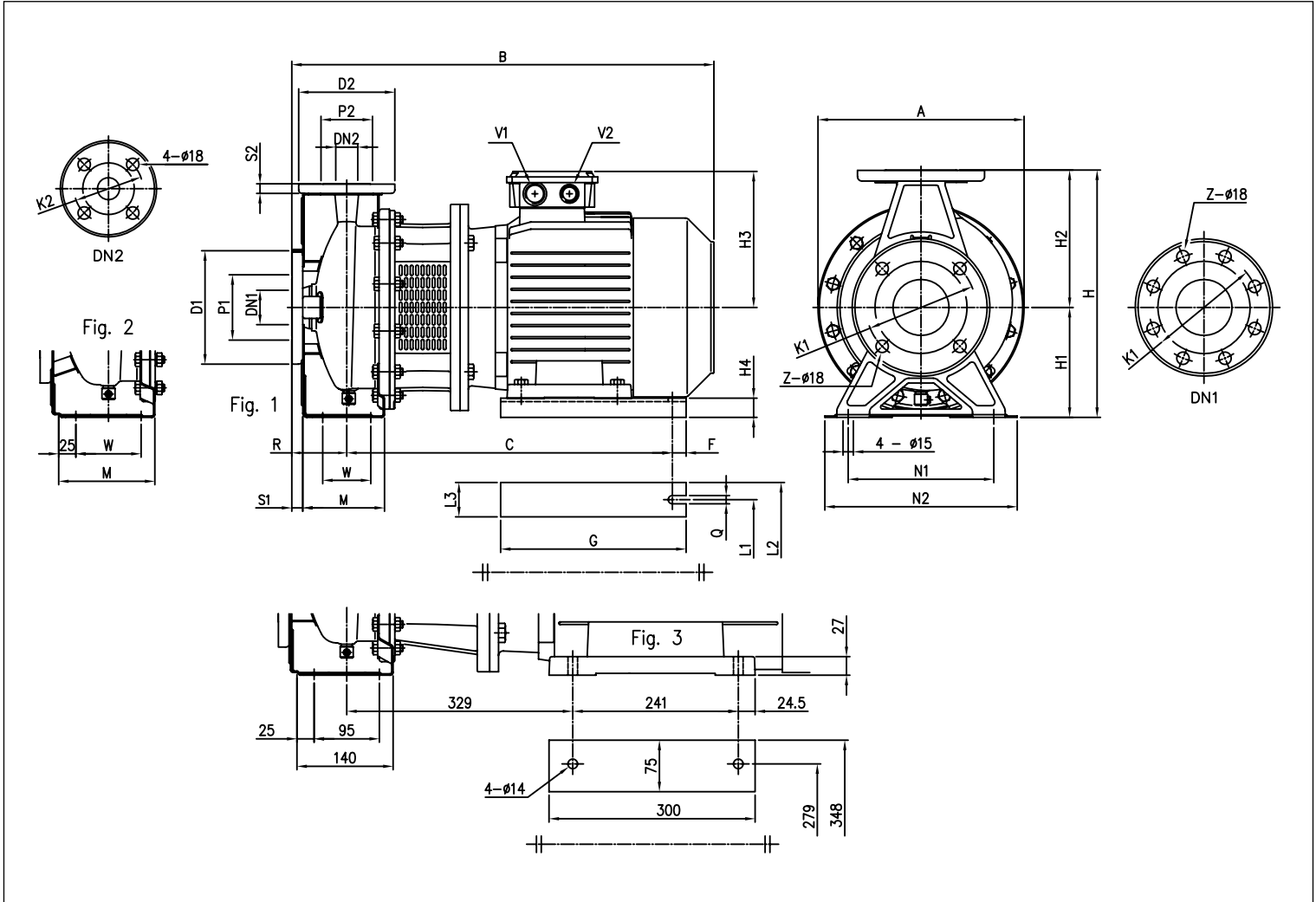

DIMENSIONAL TABLE

Model	Dimensions [mm]																										Weight [kg]													
	DN1 Ø	P1 Ø	K1 Ø	D1 Ø	S1	Z	[1]	[2]	DN2 Ø	P2 Ø	K2 Ø	D2 Ø	S2	Fig.	H	H1	H2	H3	H4	R	W	M	N1	N2	A	B	C	F	G	Q	L1	L2	L3	V1	V2	Weight	*			
32-200/5.5	50	95	125	165	16	4	-	-	32	75	100	140	14	1	340	160	180	198	28	80	70	119	190	240	300	607	479	15	270	12	216	266	50	M32x1.5	M32x1.5	71.8	71.8			
32-200/7.5	50	95	125	165	16	4	-	-	32	75	100	140	14	1	340	160	180	198	28	80	70	119	190	240	300	607	479	15	270	12	216	266	50	M32x1.5	M32x1.5	-	87.0			
40-160/3.0	65	115	145	185	16	4	-	-	40	80	110	150	14	1	292	132	160	155	32	80	70	118	190	240	254	528	388	15	220	12	160	200	40	M25x1.5	M20x1.5	42.5	42.5			
40-160/4.0	65	115	145	185	16	4	-	-	40	80	110	150	14	1	292	132	160	171	20	80	70	118	190	240	254	550	395	15	220	12	190	240	50	M25x1.5	M20x1.5	44.6	44.6			
40-200/5.5	65	115	145	185	16	4	-	-	40	80	110	150	14	2	340	160	180	198	28	100	70	115	212	265	300	627	479	15	270	12	216	266	50	M32x1.5	M32x1.5	72.2	72.2			
40-200/7.5	65	115	145	185	16	4	-	-	40	80	110	150	14	2	340	160	180	198	28	100	70	115	212	265	300	627	479	15	270	12	216	266	50	M32x1.5	M32x1.5	-	82.0			
50-125/3.0	65	115	145	185	16	4	-	-	50	95	125	165	16	2	292	132	160	155	32	100	70	114	190	240	254	548	388	15	220	12	160	200	40	M25x1.5	M20x1.5	35.5	35.5			
50-125/4.0	65	115	145	185	16	4	-	-	50	95	125	165	16	2	292	132	160	171	20	100	70	114	190	240	254	570	395	15	220	12	190	240	50	M25x1.5	M20x1.5	45.6	45.6			
50-160/5.5	65	115	145	185	16	4	-	-	50	95	125	165	16	2	340	160	180	198	28	100	70	115	212	265	300	627	479	15	270	12	216	266	50	M32x1.5	M32x1.5	63.8	63.8			
50-160/7.5	65	115	145	185	16	4	-	-	50	95	125	165	16	2	340	160	180	198	28	100	70	115	212	265	300	627	479	15	270	12	216	266	50	M32x1.5	M32x1.5	-	91.0			
50-200/9.2	65	115	145	185	16	4	-	-	50	95	125	165	16	2	360	160	200	198	28	100	70	115	212	265	300	667	479	15	270	12	216	266	50	M32x1.5	M32x1.5	-	90.7			
65-125/5.5	80	134	160	200	18	8	4	65	115	145	185	16	2	340	160	180	198	28	100	95	140	212	280	300	627	479	15	270	12	216	266	50	M32x1.5	M32x1.5	60.0	60.0				
65-125/7.5	80	134	160	200	18	8	4	65	115	145	185	16	2	340	160	180	198	28	100	95	140	212	280	300	627	479	15	270	12	216	266	50	M32x1.5	M32x1.5	-	79.4				
65-160/7.5	80	134	160	200	18	8	4	65	115	145	185	16	2	360	160	200	198	28	100	95	140	212	280	300	627	479	15	270	12	216	266	50	M32x1.5	M32x1.5	-	82.4				
65-160/9.2	80	134	160	200	18	8	4	65	115	145	185	16	2	360	160	200	198	28	100	95	140	212	280	300	667	479	15	270	12	216	266	50	M32x1.5	M32x1.5	-	88.0				
65-200/15	80	134	160	200	18	8	4	65	115	145	185	16	2	405	180	225	238	20	100	95	140	250	320	350	806	621	20	350	14	254	314	60	M40x1.5	M40x1.5	-	138.0				
65-200/18.5	80	134	160	200	18	8	4	65	115	145	185	16	2	405	180	225	238	20	100	95	140	250	320	350	850	621	20	350	14	254	314	60	M40x1.5	M40x1.5	-	137.2				
65-200/22	80	134	160	200	18	8	4	65	115	145	185	16	3	405	180	225	268	-	100	-	-	250	320	350	885	-	-	-	-	-	-	-	-	-	-	-	M32x1.5	M32x1.5	-	175.0